

DODGE TRUCK

PARTS LIST

MODEL T-203-B



Chrysler Corporation

EXPORT DIVISION

DETROIT, MICHIGAN, U. S. A.

DODGE TRUCK

PARTS LIST

CAB WITH CARGO BODY

MODEL SERIES T-203-B

ISSUED SEPTEMBER 10, 1940

STARTING SERIAL NUMBER 8,833,601

Group 1 Accessories
Group 2 Axle—Front
Group 3 Axle—Rear
Group 4 Brake—Hand
Group 5 Brake—Service
Group 6 Clutch
Group 7 Cooling
Group 8 Electrical
Group 9 Engine
Group 10 Engine Oiling
Group 11 Exhaust
Group 12 Fenders & Sheet Metal
Group 13 Frame
Group 14 Fuel
Group 15 Hood
Group 16 Prop. Shaft & U. Joint
Groups 17 Springs
Group 18 Standard Parts
Group 19 Steering
Group 20 Tools
Group 21 Transmission
Group 22 Wheels
Group 23 Body

GROUP 1 ACCESSORIES

	Part No.	Per Truck		Part No.	Per Truck
GROUP 1-A FRONT BUMPER					
FRONT BUMPER					
Front bar	588791	1	Nut (3/8 - 24)	120369	4
Bracket - upper.	576459	2	Lockwasher (3/8)	120382	4
Bracket - lower.	588792	2	Plainwasher (3/8)	120394	4
Bolt (bracket to frame).			GROUP 1-B REAR BUMPER		
(1/2 - 20 x 1 1/4)	120424	6	REAR BUMPER		
Nut (1/2 - 20)	120371	6	Bumper - prime	598297	2
Lockwasher (1/2)	120384	6	Bolt (bumper to frame)	601318	8
Bolt (bracket to bar)			Nut (1/2 - 20)	120371	8
(1/2 - 20 x 1 1/4)	120424	4	Lockwasher (1/2)	120384	8
Nut (1/2 - 20)	120371	4	Plainwasher (1/2)	120390	8
Lockwasher (1/2)	120384	4			
Bolt (bracket to tow hook)					
(3/8 - 24 x 1 1/2)	120677	4			

* Indicates amount used as required.

GROUP 2 FRONT AXLE

Plate 1

FRONT AXLE HUB AND UNIVERSAL DRIVE ASSEMBLY (RZEPPA JOINT)

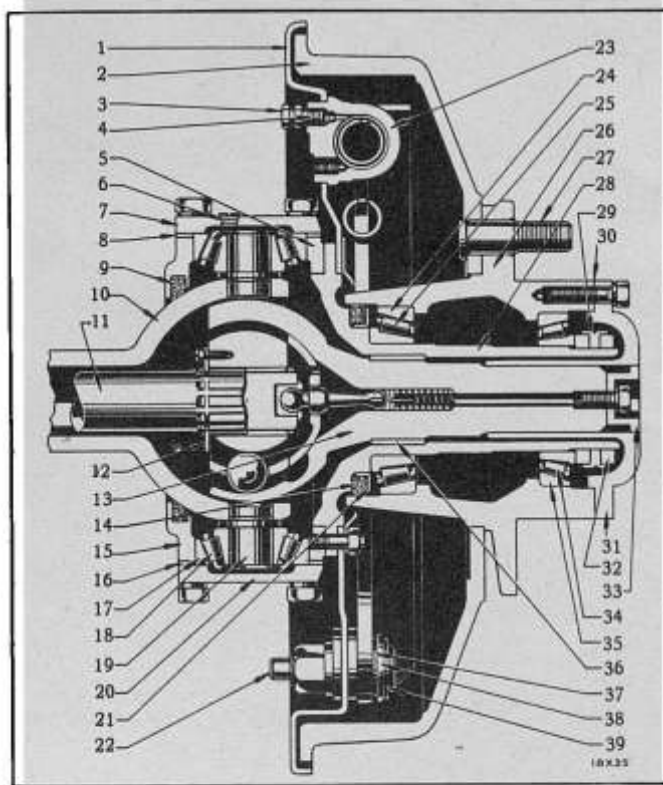

Plate 1

Ref No.	Part Name	Part No.	Group	Ref No.	Part Name	Part No.	Group
1	Front wheel brake support	598400	5-C	18	Steering knuckle flange bearing cone and rollers.	568463	2-H
2	Wheel brake drum	598514	22-B	19	Trunion socket pin	568444	2-E
3	Wheel cylinder bleeder screw cap screw	123291	5-J	20	Steering knuckle flange bearing cap--lower.	568468	2-H
4	Wheel cylinder bleeder screw	77671	5-J	21	Front wheel bearing felt retainer	568482	22-C
5	Steering knuckle companion flange (serviced in differential carrier and axle housing tube assembly)	---	---	22	Brake shoe anchor bolt	871434	5-C
6	Steering knuckle flange bearing cap grease plug	103883	2-H	23	Front brake wheel cylinder assembly	871934	5-J
7	Steering knuckle flange bearing cap--upper.	568464	2-H	24	Front wheel bearing cup--inner.	598576	22-C
8	Steering knuckle flange bearing cap shaft.	568465-568466-568467	2-H	25	Front wheel bearing cone and rollers--inner	598575	22-C
9	Steering knuckle flange felt.	568461	2-H	26	Front wheel hub	598512	22-B
10	Front axle housing (serviced in differential carrier and axle housing tube assembly)	---	---	27	Wheel stud.	568494-568495	22-B
11	Universal drive shaft (inner splined)	568474	2-F	28	Steering knuckle.	568454	2-H
12	Universal drive shaft retainer.	573945	2-F	29	Front wheel bearing adjusting nut lock.	568484	22-C
13	Universal drive assembly (less inner splined shaft)	599034	2-F	30	Universal drive flange gasket	598573	2-G
14	Front wheel bearing felt.	568481	22-C	31	Universal drive flange.	598516	2-G
15	Steering knuckle flange (serviced in differential carrier and axle housing tube assembly)	---	---	32	Front wheel bearing adjusting nut	568483	22-C
16	Steering knuckle flange bearing shim.	568465-568466-568467	2-H	33	Universal drive shaft stop.	568476	2-F
17	Steering knuckle flange bearing cup	568462	2-H	34	Front wheel bearing cone and rollers--outer	568480	22-C
				35	Front wheel bearing cup--outer.	527745	22-C
				36	Steering knuckle bushing.	568470	2-H
				37	Brake shoe anchor bolt felt washer.	536237	5-C
				38	Brake shoe anchor bolt felt washer retainer	536238	5-C
				39	Brake shoe anchor bolt "C" washer	536244	5-C

Plate 2

DRAG LINK

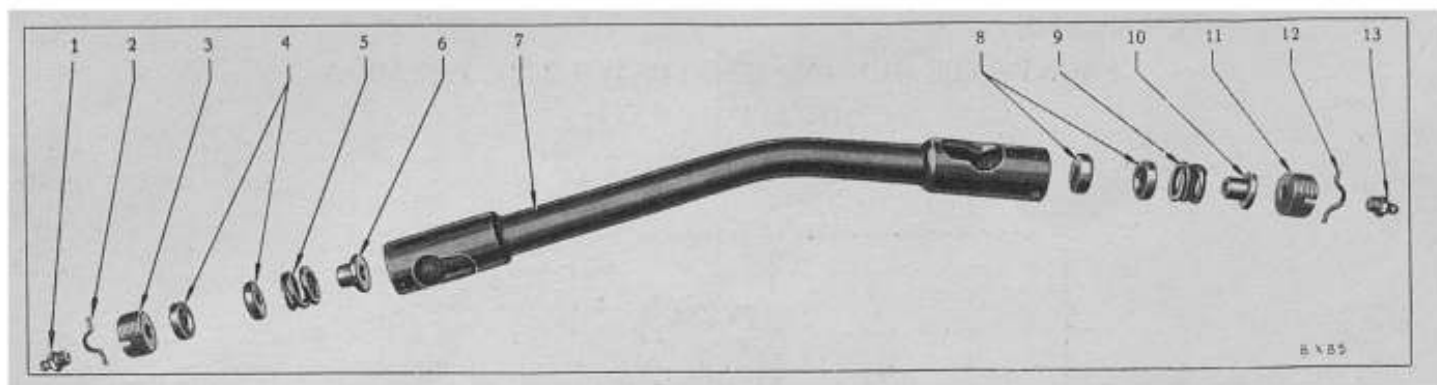

Plate 2

Ref No.	Part Name	Part No.	Group	Ref No.	Part Name	Part No.	Group
1	Lubricant nipple.	145433-109365	2-I	8	Ball sockets.	502182	2-I
2	End plug lock wire.	318759	2-I	9	Spring.	318748	2-I
3	End plug.	516219	2-I	10	End bumper.	562571	2-I
4	Ball sockets.	502182	2-I	11	End plug.	516219	2-I
5	Spring.	318748	2-I	12	End plug lock wire.	318759	2-I
6	End bumper.	562571	2-I	13	Lubricant nipple.	145433-109365	2-I
7	Drag link tube.	589543	2-I				

Part No.	Per Truck	Part No.	Per Truck
GROUP 2-A FRONT AXLE		DIFFERENTIAL CASE	
FRONT AXLE ASSEMBLY - COMPLETE		Case assembly (includes right and left halves only)	568376 1
Note - Complete assembly will be serviced on special orders only.		Screw	568509 8
Note - For identification of universal drive a metal tag showing type is attached to the front of the front axle housing.		Lockwire	568384 1
GROUP 2-B FRONT AXLE HOUSING		DIFFERENTIAL SIDE GEAR	
FRONT AXLE HOUSING ASSEMBLY		Gear	916067 2
Assembly (see differential carrier and axle housing tube assembly).		Thrustwasher	596776 2
Vent nipple	668513 1	DIFFERENTIAL PINION	
Cap.	557056 1	Pinion	916069 4
Cotter (3/32 x 3/4)	103373 1	Thrustwasher	596775 4
GROUP 2-C DIFFERENTIAL		DIFFERENTIAL SPIDER	
DIFFERENTIAL AND CARRIER		Spider	599240 1
Carrier and axle housing tube assembly - right	599330 1	DIFFERENTIAL BEARING	
Carrier and axle housing tube assembly - left	599331 1	Cup	563568 2
Gasket	568372 1	Cone	563567 2
Bolt	568525 11	Shim (.005")	568387 *
Lockwasher (7/16)	120383 11	Shim (.010")	568388 *
Nut (7/16 - 20)	120370 11	GROUP 2-D DRIVE GEAR AND PINION	
Plug (3/4 - 14 x 1-1/16)	103869 2	DRIVE GEAR AND PINION	
		Matched set (6.6 to 1 ratio)	594128 1
		Consists of:	
		Gear (33 teeth)	568391 1
		Pinion (5 teeth)	568392 1

* Indicates amount used as required.

	Part No.	Per Truck
GROUP 2-D DRIVE GEAR AND PINION (CONTINUED)		
DRIVE GEAR THRUST BLOCK AND RIVET		
Thrust block	568365	1
Pin.	568527	1
Rivet.	568513	12
GROUP 2-E DRIVE PINION BEARINGS		
DRIVE PINION INNER BEARING		
Assembly	589316	1
Race	568394	1
Lock	568395	1
Retainer	568374	1
Trunnion socket bearing pin.	568444	4
DRIVE PINION OUTER BEARING		
Cage assembly (includes bearing cups).	568397	1
Screw (9/16 - 12 x 1-1/4).	120895	6
Lockwasher (9/16).	120898	6
Cup.	537819	2
Cone	56203	2
Shim	568528	*
Retainer cork (seal)	568399	1
Adjustment nut	568515	2
Lock	568398	2
Washer	568514	1
Oil seal and cover assembly.	568403	1
Oil seal - only.	568404	1
GROUP 2-F UNIVERSAL DRIVE		
UNIVERSAL DRIVE ASSEMBLY		
Assembly (less inner splined shaft) (Rzeppa)	599034	2
Shaft (right) (inner splined shaft) (Rzeppa).	568474	1
Shaft (left) (inner splined shaft) (Rzeppa).	568475	1
Retainer (shaft) (Rzeppa).	573945	2
Screw (Rzeppa)	573943	2
Stop (shaft)	568476	2
Screw (Rzeppa)	599344	2
Lockwasher (7/16).	120383	2
Nipple (Rzeppa).	145433	2
Pivot (Rzeppa)	573939	2
Pin (Rzeppa)	573940	2
Seat (Rzeppa).	573935	2
Ball (Rzeppa).	573938	12
Ball cage (Rzeppa)	573937	2
Ball inner race (Rzeppa)	599036	2
Outer race bell (or outer splined shaft) (Rzeppa).	599035	2
Buffer spring (Rzeppa)	573946	2
Plunger (Rzeppa)	573941	2
Spring (Rzeppa).	573942	2
Note - Drive pinion companion flange or yoke--See Propeller Shaft Group 16.		

	Part No.	Per Truck
GROUP 2-G DRIVE FLANGE		
DRIVE FLANGE		
Flange	598516	2
Gasket	598573	2
Stud	598766	16
Nut (3/8 - 24)	120369	16
Lockwasher (3/8)	120381	16
Puller screw (3/8 - 16 x 1).	102896	4
Nut (3/8 - 16)	134566	4
GROUP 2-H STEERING KNUCKLE, FLANGE AND ARM		
STEERING KNUCKLE		
Assembly (includes bushing).	568454	2
Bushing.	568470	2
STEERING KNUCKLE FLANGE		
Bushing.	568459	2
Felt	568461	2
Felt pressure spring	589474	2
Stud	589475	24
Nut (3/8 - 24)	115287	24
Lockwasher (3/8)	138489	24
Stop screw	595067	2
Nut.	595068	2
Bearing cup.	568462	4
Bearing cone	568463	4
Bearing cap--upper	568464	1
Stud (long)	598751	6
Stud (short)	912285	6
Nut (1/2 - 20)	120371	6
Nut (1/2 - 20)	124934	2
Lockwasher (1/2)	138549	8
Shim (.005")	568466	*
Shim (.010")	568465	*
Shim (.030")	568467	*
Bearing cap--lower	568468	2
Screw (1/2 - 13 x 1-1/4)	120426	8
Lockwasher (1/2)	131101	8
Grease plug (1/8 - 27 x 7/16).	103883	2
Bolt (knuckle companion flange) (3/8 - 24 x 1-1/4)	121615	24
Nut (3/8 - 24)	120369	24
Lockwasher (3/8)	120381	24
Note - Steering knuckle flange and companion flange serviced in differential carrier and axle housing tube assembly. See Group 2-C.		
STEERING ARM		
Arm.	568472	1
Ball	568473	1
Nut.	568529	1
Cotter (1/8 x 1-1/4)	103386	1
GROUP 2-I DRAG LINK		
DRAG LINK		
Assembly	589542	1
Tube	589543	1
Socket (ball).	502182	4

* Indicates amount used as required.

Dodge Truck Parts List

		Part No.	Per Truck			Part No.	Per Truck
GROUP 2-I DRAG LINK (CONTINUED)				GROUP 2-J STEERING TIE ROD			
DRAG LINK (Cont'd.)				STEERING TIE ROD			
Spring (ball)		318748	2	Assembly (includes ends)		568486	1
Dust cover (ball) (steering gear end)		636926	1	End--right		568488	1
Wire (steering gear end)		636925	1	End--left		589477	1
Retainer (steering gear end)		644264	1	Pin (end)		568570	2
Dust cover (outer) (axle end)		612576	1	Nut		568529	2
Dust cover (inner) (axle end)		612577	1	Locknut		589480	1
Pad (dust cover) (axle end)		612578	1	Cotter (1/8 - 1-1/4)		103386	2
Grease nipple--front (1/8)		145433	1	Oiler		145435	2
Grease nipple--rear (1-3/16)		109365	1	Clamp bolt (end) (1/2 - 20 x 2-1/4)		124174	4
End bumper		562571	2	Nut (1/2 - 20)		120371	4
End plug		516219	2	Lockwasher (1/2)		131101	4
Lock		318759	2				

* Indicates amount used as required.